



American Weigh Scales

AMW-BENCH User Manual



- AMW-500i (500 x 0.1g)
- AMW-1000 (1000 x 0.1g)
- AMW-2000 (2000 x 0.1g)
- AMW-13 (13lb x 0.1oz)



AMW-BENCH

Thank you for purchasing the American Weigh AMW-BENCH digital bench scale. Please read all operating instructions carefully before use. Scales are precision measuring devices and should always be handled with proper care. To ensure years of reliable service, keep these simple tips in mind:

- Do not exceed the scale's maximum capacity. Overloading your scale can permanently damage it!
- Avoid exposure to extreme heat or cold. Scales perform best at normal room temperature. If temperatures have changed dramatically, calibration and adjustment may be necessary.
- Allow your scale to warm up for 30-60 seconds before performing calibration and adjustment(if available).
- Store your scale in a clean, dry location. Dust, dirt, and moisture can accumulate on the weighing sensors and electronics causing inaccuracy or malfunction.
- Avoid using your scale in close proximity to strong radio wave emitting devices such as computers, cash registers, and cordless phones.
- Always weigh on a flat and level surface, free from vibrations and drafts. The corner of a room is usually the most stable.
- Gently apply all items to be weighed. Do not drop items onto the weighing platform.
- Avoid dropping your scale. The warranty does not cover damage due to rough treatment or overload.
- Check the batteries first if you are having any trouble with your scale. This simple step can remedy most scale issues.
- Do not disassemble your scale. This product contains no user serviceable parts.

I. Part List

1. Scale
2. 9V Battery (x1)

II. Key Description

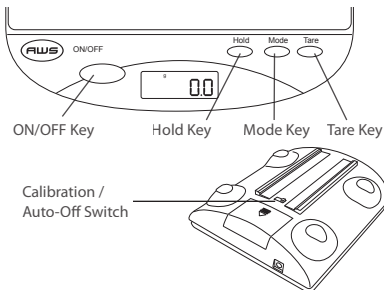

ON/OFF Key- Turns scale ON or OFF

Hold Key- Press to hold the current weight on the display. Press again to return to normal weighing.

Mode Key- Changes displayed unit of measure

Tare Key- Subtracts the current displayed weight to set the display back to zero. See section VI.

Auto-Off Switch- Turns the auto-off feature ON or OFF. Also has a calibration mode setting.

III. Battery Installation

1. When installing the battery, make sure the positive and negative contacts are properly aligned.

IV. Operation

1. Place the scale on a flat, level surface and press the **ON/OFF** key to turn the scale on.
2. Once the start-up process completes and the scale goes to zero you are ready to weigh.
3. Place the quantity to be weighed onto the weighing platform.
4. Wait a couple seconds for the display to stabilize before taking a weight reading.

V. Auto-Off Feature

1. To disable or enable the auto-off feature, use the switch on the underside of the scale.

VI. Changing the Unit of Measure

1. Press the **MODE** key to change the scales displayed unit of measure.
2. If the scale is turned off then back on, it will default to the last unit used.
 - **AMW-500i, AMW-1000, AMW-2000 Units:** g (gram) ▶ oz (ounce) ▶ ozt (troy ounce) ▶ dwt (pennyweight)
 - **AMW-13 Units:** lb/oz (pound/ounce) ▶ oz (ounce) ▶ kg (kilogram) ▶ g (gram)

VII. Using the Tare Feature

You can use this scale's tare feature to subtract the weight of an empty container or vessel for net weight determination.

NOTE: The weight of the container will subtract from the available capacity.

1. Place the empty container or vessel on the weighing platform.
2. Press the **TARE** key once. The display will then

reset to zero. If the container is removed, it's weight will be displayed as a negative number.

3. You may now fill the container with the quantity to be weighed. The display will show the net weight of the contents.
4. To return to normal weight display (gross weight), remove any items from the weighing platform and press the **TARE** key again to re-zero the scale.

VIII. Calibration

Calibration and adjustment are performed at the factory. However, the weighing range can shift slightly during shipping. Also, due to changes in local acceleration of gravity around the world, adjustment is recommended when moving the scale from one location to another. To check calibration:

1. Place the required calibration weight on the scale and note the displayed value.
2. If the displayed value is not within acceptable tolerance (see chart below), adjustment is required.

Model	Acceptable Tolerance (\pm)	Calibration Weight	Recommended Accuracy Class
AMW-500i	0.2g	500g	OIML M2
AMW-1000	0.2g	1000g	OIML M2
AMW-2000	0.2g	2000g	OIML M2
AMW-13	2g	5000g	OIML M2

IX. Adjustment

1. Turn the scale over and set the switch on the bottom to "Calibration"
2. Turn the scale right side up again and press the **ON/**

OFF key to turn the scale on.

3. Press and hold the **MODE** key until the display shows "CAL".
4. Press the **MODE** key again. The display will flash "CAL" followed by the calibration weight value (see chart on page 5).
5. Place the calibration weight on the center of the weighing platform. Make sure you are using the correct weight for your specific model.
6. Once the weight is accepted, the display will show "PASS" then return to normal operation. Turn the scale off and return the switch on the bottom to Auto-Off Enabled or Auto-Off Disabled.

X. Troubleshooting

- **Problem:** Scale will not turn on
- **Solution:** Check the batteries

- **Problem:** Displayed weight fluctuates randomly
- **Solution:** Make sure your workspace is stable and free of any air currents or vibration

- **Problem:** Displayed weight is inaccurate
- **Solution:** Perform a calibration adjustment

XI. Error Codes

1. **OUTZ** - Zero range has shifted. Perform calibration adjustment. If the problem persists, the load cell may be permanently damaged due to overloading.
2. **o-Ld** - Maximum capacity exceeded. Remove the

extra weight to avoid damaging the load cell.

XII. Specifications

	AMW-500i	AMW-1000
Max. Capacity	500g	1000g
Readability	0.1g	0.1g
Power	1x (One) 9V Battery	
Dimensions	1.6 x 6.2 x 7.2"	
Platform Dimensions	6.0 x 6.0"	
Warranty	10 Year Limited Warranty	

	AMW-2000	AMW-13
Max. Capacity	2000g	6000g
Readability	0.1g	1g
Power	1x (One) 9V Battery	
Dimensions	1.6 x 6.2 x 7.2"	
Platform Dimensions	6.0 x 6.0"	
Warranty	10 Year Limited Warranty	

XIII. Capacity/Readability Charts

AMW-500i	AMW-1000
500x0.1g	1000x0.1g
17.64x0.01oz	35.27x0.01oz
16.08x0.01ozt	32.15x0.01ozt
321.5x0.1dwt	643.1x0.1dwt

AMW-2000	AMW-13
2000x0.1g	13lb x 0.1oz
70.55x0.01oz	6kg x 1g
64.30x0.01ozt	
1286x0.1dwt	